

Low Impedance Speakers *Warning: Never install horn speaker in oily place to prevent an accident, adhesion of oil may deteriorate speakers' junction.

CA-211

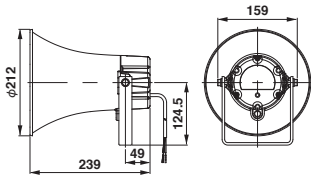

- Rated input** 10W
- Impedance** 8Ω
- SPL** 107dB (1W/1m)
- Frequency response** 315Hz~8kHz
- Finish** Horn mouth, Reflector (ASA resin): Silver gray, Cover (ASA resin): Silver gray, Bracket (Stainless)
- Mass** Approx. 1.4kg

JIS C 0920
IEC 60529 (IP65)

CA-151

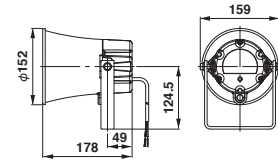

- Rated input** 5W
- Impedance** 8Ω
- SPL** 105dB (1W/1m)
- Frequency response** 400Hz~8kHz
- Finish** Horn mouth (ASA resin): Silver gray, Reflector (ASA resin): Silver gray, Cover (ASA resin): Silver gray, Bracket (Stainless)
- Mass** Approx. 1.2kg

JIS C 0920
IEC 60529 (IP65)

CP-121

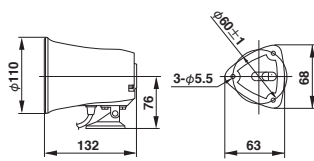

- Rated input** 5W
- Impedance** 8Ω
- SPL** 100dB (1W/1m)
- Frequency response** 500Hz~4kHz
- Finish** Horn mouth, Reflector (ABS resin): Ivory, Swivel (ABS resin): Black, Fittings (Iron): Black
- Mass** Approx. 530g

CP-11/4

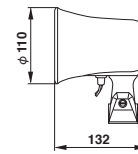

- Rated input** 5W
- Impedance** 4Ω
- SPL** 100dB (1W/1m)
- Frequency response** 500Hz~4kHz
- Finish** Horn mouth, Reflector (ABS resin): Ivory, Fittings (Iron)
- Mass** Approx. 630g

CV-381A <CV-381 / 25A> <CV-381 / 35A>

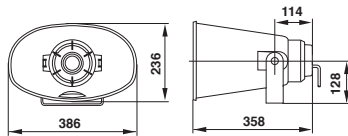

- Rated input** 20W
25W <CV-381/25A>
35W <CV-381/35A>
- Impedance** 8Ω
- SPL** 107dB (1W/1m) CV-381A, <CV-381/25A>
108dB (1W/1m) <CV-381/35A>
- Frequency response** 250Hz~6.3kHz
- Finish** Horn mouth, Reflector, Cover (ASA resin): Silver gray, Bracket (Steel): Silver gray
- Mass** Approx. 2.6kg CV-381A, <CV-381/25A>
Approx. 2.8kg <CV-381/35A>

JIS C 0920
IEC 60529 (IP65)

CJ-14

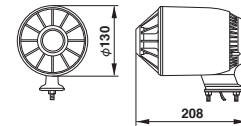

- Rated input** 10W
- Impedance** 8Ω
- SPL** 102dB (1W/1m)
- Frequency response** 320Hz~7kHz
- Finish** Horn mouth (ABS resin): Ivory, Reflector, Rover, Fittings (ABS resin): Dark gray
- Mass** Approx. 1.0kg

CK-231/15

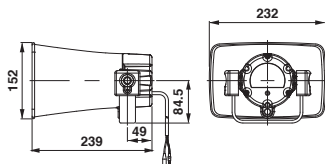

- Rated input** 15W
- Impedance** 8Ω
- SPL** 108dB (1W/1m)
- Frequency response** 320Hz~7.5kHz
- Finish** Horn mouth, Reflector (ASA resin): Silver gray, Cover (ASA resin): Silver gray, Bracket (Stainless)
- Mass** Approx. 1.4kg

JIS C 0920
IEC 60529 (IP65)

CK-231/10

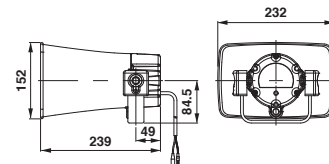

- Rated input** 10W
- Impedance** 8Ω
- SPL** 108dB (1W/1m)
- Frequency response** 320Hz~7.5kHz
- Finish** Horn mouth, Reflector (ASA resin): Silver gray, Cover (ASA resin): Silver gray, Bracket (Stainless)
- Mass** Approx. 1.4kg

JIS C 0920
IEC 60529 (IP65)

High Impedance Speakers *Warning: Never install horn speaker in oily place to prevent an accident, adhesion of oil may deteriorate speakers' junction.

CT-510B

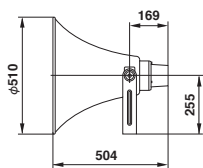

- Rated input** 30W
- Impedance** 330/500/670Ω (100V line)
- SPL** 108dB (1W/1m)
- Frequency response** 225Hz~7kHz
- Finish** Horn mouth (Aluminum): Light gray
Reflector (ABS resin): Light gray
Cover (ABS resin): Gray
Bracket (SPCC): Hot-dip galvanizing
- Mass** Approx. 4.3kg

JIS C 0920
IEC 60529 (IP65)

CT-380A / 20

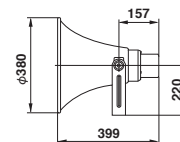

- Rated input** 20W
- Impedance** 500/1k/2kΩ (100V line)
- SPL** 106dB (1W/1m)
- Frequency response** 250Hz~8kHz
- Finish** Horn mouth (Aluminum): Light gray
Reflector (ABS resin): Light gray
Cover (ABS resin): Gray
Bracket (SPCC): Hot-dip galvanizing
- Mass** Approx. 3.0kg

JIS C 0920
IEC 60529 (IP65)

CT-211

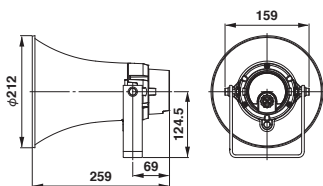

- Rated input** 10W
- Impedance** 1k/2k/4kΩ (100V line)
- SPL** 106dB (1W/1m)
- Frequency response** 315Hz~7kHz
- Finish** Horn mouth,
Reflector (ASA resin): Silver gray
Cover (ASA resin): Silver gray
Bracket (Stainless)
- Mass** Approx. 1.6kg

JIS C 0920
IEC 60529 (IP65)

CT-151

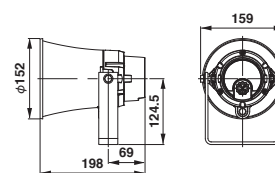

- Rated input** 5W
- Impedance** 2k/3.3k/10kΩ (100V line)
- SPL** 105dB (1W/1m)
- Frequency response** 400Hz~8kHz
- Finish** Horn mouth,
Reflector (ASA resin): Silver gray
Cover (ASA resin): Silver gray
Bracket (Stainless)
- Mass** Approx. 1.3kg

JIS C 0920
IEC 60529 (IP65)

CKT-231

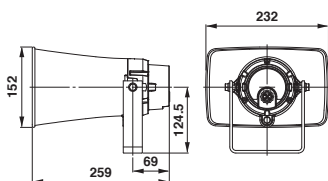

- Rated input** 10W
- Impedance** 1k/2k/4kΩ (100V line)
- SPL** 107dB (1W/1m)
- Frequency response** 320Hz~7.5kHz
- Finish** Horn mouth, Reflector, Cover
(ASA resin): Silver gray
Bracket (Stainless)
- Mass** Approx. 1.6kg

JIS C 0920
IEC 60529 (IP65)

Explosion-proof Speakers

PEH-30T

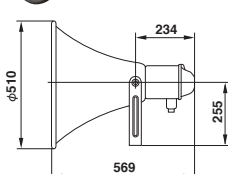

PEH series are suitable for explosive gas and ignition environments such as oil refinery, factory, chemical plant and oil rig. Special insulation construction can prevent earth and short circuit.

- Rated input** 30W
- Impedance** 330/500/670/1kΩ (100V line)
- SPL** 110dB (1W/1m)
- Frequency response** 250Hz~4kHz
- Finish** Horn mouth(Aluminum): Metallic gray
Reflector (ABS resin): Metallic gray
Cover (Aluminum diecasting): Metallic gray
Bracket (SPHC): Metallic gray
- Mass** Approx. 7.2kg

PEH-15T

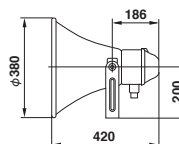

PEH series are suitable for explosive gas and ignition environments such as oil refinery, factory, chemical plant and oil rig. Special insulation construction can prevent earth and short circuit.

- Rated input** 15W
- Impedance** 670/1k/1.3k/2kΩ (100V line)
- SPL** 107dB (1W/1m)
- Frequency response** 300Hz~4kHz
- Finish** Horn mouth(Aluminum): Metallic gray
Reflector (PS resin): Metallic gray
Cover (Aluminum diecasting): Metallic gray
Bracket (SPHC): Metallic gray
- Mass** Approx. 4.2kg

Separate Horns

H-510A

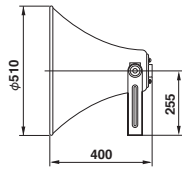

Finish Horn mouth (Aluminum): Light gray
Reflector (ABS resin): Light gray
Bracket (SPHC): Hot-dip galvanizing

Mass Approx. 2.7kg

H-380A

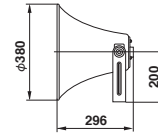

Finish Horn mouth (Aluminum): Light gray
Reflector (ABS resin): Light gray
Bracket (SPHC): Hot-dip galvanizing

Mass Approx. 2.0kg

HK-400

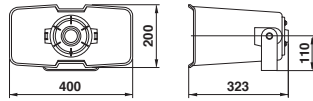

Finish Horn mouth,
Reflector (ABS resin): Light gray
Bracket (SPHC): Gray

Mass Approx. 1.7kg

HK-315

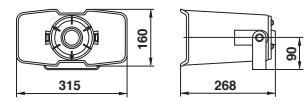

Finish Horn mouth,
Reflector (ABS resin): Light gray
Bracket (SPHC): Gray

Mass Approx. 1.3kg

Special Horns

HAC-16

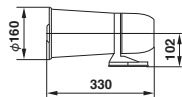

HAC-16 is designed high robust speaker for emergency vehicle, and can only combine low impedance driver unit.

Finish Horn mouth (Aluminum): White
Reflector (PS resin): White
Cover (ABS resin): White
Stand base
(Aluminum diecasting): White

Mass Approx. 0.9kg

H-381SH / <H-301SH>

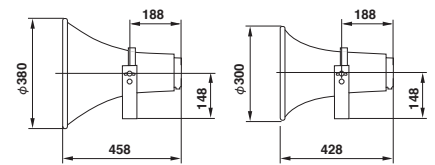

H-381SH

H-301SH

Finish Horn mouth (Aluminum): Light gray
Reflector (Aluminum): Light gray
Cover (Aluminum diecasting): Gray
Bracket (SPHC): Gray

Mass Approx. 3.4kg
Approx. 3.1kg <H-301SH>

Straight Horns

H-760L

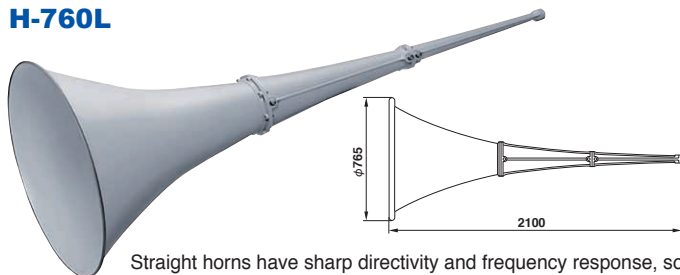

Straight horns have sharp directivity and frequency response, so that sound can be delivered for long-reach in one direction. Built radially on tower, the straight horns with high power driver unit can be wide PA system.

Finish Horn mouth (Aluminum): Light gray
1st & 2nd horn (Aluminum diecasting): Light gray

Mass Approx. 9.5kg

H-510L



Straight horns have sharp directivity and frequency response, so that sound can be delivered for long-reach in one direction. Built radially on tower, the straight horns with high power driver unit can be wide PA system.

Finish Horn mouth (Aluminum): Light gray
1st horn (Aluminum diecasting): Light gray

Mass Approx. 2.8kg

Low Impedance Driver Units

P-1000

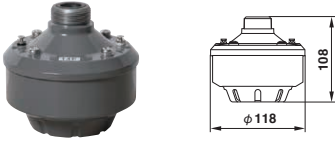

Rated input 100W
Impedance 8Ω
Frequency response 150Hz~6kHz
SPL 110dB (1W/1m)
Finish Throat (Aluminum diecasting): Gray
 Case (Aluminum): Gray
Mass Approx. 2.3kg

P-700

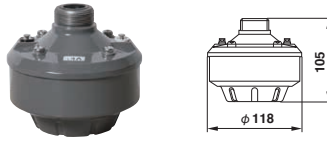

Rated input 70W
Impedance 16Ω
Frequency response 150Hz~6kHz
SPL 110dB (1W/1m)
Finish Throat (Aluminum diecasting): Gray
 Case (Aluminum): Gray
Mass Approx. 2.3kg

P-500

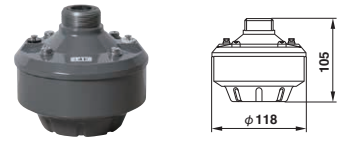

Rated input 50W
Impedance 16Ω
Frequency response 125Hz~7kHz
SPL 110dB (1W/1m)
Finish Throat (Aluminum diecasting): Gray
 Case (Aluminum): Gray
Mass Approx. 2.3kg

P-350

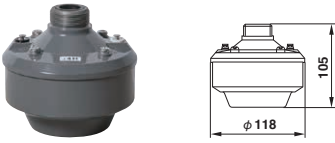

Rated input 35W
Impedance 16Ω
Frequency response 125Hz~7kHz
SPL 110dB (1W/1m)
Finish Throat (Aluminum diecasting): Gray
 Case (Aluminum): Gray
Mass Approx. 2.3kg

P-300

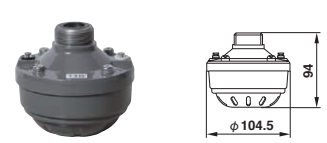

Rated input 30W
Impedance 16Ω
Frequency response 125Hz~7kHz
SPL 110dB (1W/1m)
Finish Throat (Aluminum diecasting): Gray
 Case (Aluminum): Gray
Mass Approx. 1.5kg

P-250

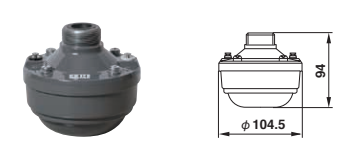

Rated input 25W
Impedance 16Ω
Frequency response 125Hz~7kHz
SPL 110dB (1W/1m)
Finish Throat (Aluminum diecasting): Gray
 Case (Aluminum): Gray
Mass Approx. 1.5kg

P-15F



Rated input 15W
Impedance 8Ω
Frequency response 160Hz~8kHz
SPL 108dB (1W/1m)
Finish Throat (Aluminum diecasting): Gray
 Case (Aluminum): Gray
Mass Approx. 0.9kg

P-800N (Neodymium magnet)



Rated input 80W
Impedance 8Ω
Frequency response 150Hz~9kHz
SPL 110dB (1W/1m)
Finish Throat (Aluminum diecasting): Gray
 Case (Aluminum): Gray
Mass Approx. 1.1kg

High Impedance Driver Units

P-500T

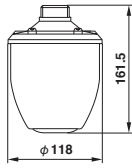

Rated input 50W
Impedance 200/250/285/330Ω (100V line)
Frequency response 150Hz~7kHz
SPL 110dB (1W/1m)
Finish Throat (Aluminum diecasting): Gray
 Case (Aluminum): Gray
Mass Approx. 3.2kg

P-350T

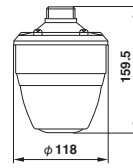

Rated input 35W
Impedance 285/330/400/500Ω (100V line)
Frequency response 125Hz~7kHz
SPL 110dB (1W/1m)
Finish Throat (Aluminum diecasting): Gray
 Case (Aluminum): Gray
Mass Approx. 3.0kg

P-300T

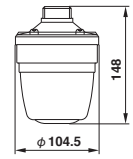

Rated input 30W
Impedance 330/400/500/1kΩ (100V line)
Frequency response 125Hz~7kHz
SPL 110dB (1W/1m)
Finish Throat (Aluminum diecasting): Gray
 Case (Aluminum): Gray
Mass Approx. 2.2kg

P-250T

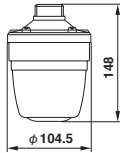

Rated input 25W
Impedance 400/500/670/1kΩ (100V line)
Frequency response 125Hz~7kHz
SPL 110dB (1W/1m)
Finish Throat (Aluminum diecasting): Gray
 Case (Aluminum): Gray
Mass Approx. 2.2kg

P-15FT

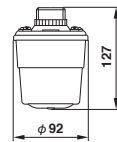

Rated input 15W
Impedance 670/1k/1.3k/2kΩ (100V line)
Frequency response 160Hz~8kHz
SPL 108dB (1W/1m)
Finish Throat (Aluminum diecasting): Gray
 Case (Aluminum): Gray
Mass Approx. 1.4kg

Unit Covers

UCS-51A



Finish (Aluminum diecasting): Gray
Mass Approx. 1.0kg
 for all driver units (excluding P-15F)

UC-8B



Finish Cover(Aluminum): Gray
Mass Approx. 240g
 for High impedance driver units

UC-7B



Finish (ABS resin): Gray
Mass Approx. 180g
 for Low impedance driver units

UCL-41A (for Straight horns only)



Finish (Aluminum diecasting): Gray
Mass Approx. 1.0kg
 for all driver units (excluding P-15F)

Special Horn

UF-770

UF-770 is designed high robust speaker for emergency vehicle.

Finish Horn mouth (Aluminum diecasting): Gray
 Reflector (PA resin): Gray
Mass Approx. 650g

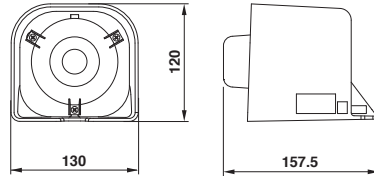

Driver Units for emergency vehicle

UF-D100N

(Neodymium magnet)

New driver unit employing a neodymium speaker magnet can reduce the mass and improve performance comparing to ferrite magnet.

Rated input 100W
Impedance 11Ω
Frequency response 300Hz~5kHz (with UF-770)
SPL 100dB (1W/1m)
Finish Throat (Aluminum diecasting): Gray
 Case (Aluminum): Gray
Mass Approx. 1.6kg

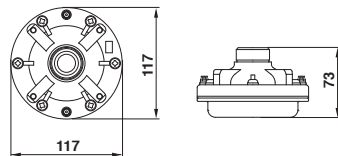

UF-D50N

(Neodymium magnet)

New driver unit employing a neodymium speaker magnet can reduce the mass and improve performance comparing to ferrite magnet.

Rated input 50W
Impedance 16Ω
Frequency response 300Hz~5kHz (with UF-770)
SPL 102dB (1W/1m)
Finish Throat (Aluminum diecasting): Gray
 Case (Aluminum): Gray
Mass Approx. 1.0kg

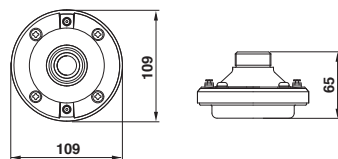

UF-D30N

(Neodymium magnet)

New driver unit employing a neodymium speaker magnet can reduce the mass and improve performance comparing to ferrite magnet.

Rated input 30W
Impedance 16Ω
Frequency response 350Hz~5kHz (with UF-770)
SPL 102dB (1W/1m)
Finish Throat (Aluminum diecasting): Gray
 Case (Aluminum): Gray
Mass Approx. 0.9kg

